

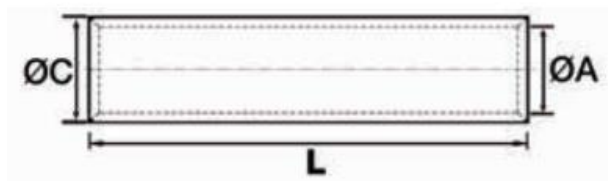

MORRIS CAT#: 94510-94542

Copper Long Barrel Compression Splices



Features:

- High Conductivity Seamless Copper
- Electro-Tin Plating Resists Corrosion, Reduces Contact Resistance for Maximum Conductivity
- Beveled Entry for Easy Insertion
- Color Coded Die Index and Crimp Marks Printed on Barrel
- UL 486A Listed for Applications Thru 35KV

DIMENSIONS = INCHES

CAT. NO.	WIRE RANGE	COLOR CODE	A	C	LENGTH	BOX QTY
94510	8 STR.	RED	.172	.272	2.01	60
94512	6 STR.	BLUE	.203	.297	2.36	40
94514	4 STR.	GRAY	.250	.344	2.36	25
94516	2 STR.	BROWN	.315	.422	2.60	18
94518	1 STR.	GREEN	.360	.469	2.87	15
94520	1/0 STR.	PINK	.390	.520	2.87	10
94522	2/0 STR.	BLACK	.441	.563	3.11	20
94524	3/0 STR.	ORANGE	.492	.622	3.11	16
94526	4/0 STR.	PURPLE	.547	.688	3.39	12
94528	250 MCM	YELLOW	.594	.750	3.39	12
94530	300 MCM	WHITE	.658	.813	4.13	9
94532	350 MCM	RED	.700	.875	4.13	6
94534	400 MCM	BLUE	.764	.949	4.37	6
94536	500 MCM	BROWN	.835	1.063	4.61	6
94538	600 MCM	GREEN	.925	1.188	5.35	4
94540	750 MCM	BLACK	1.03	1.31	5.87	4
94542	1000 MCM	WHITE	1.15	1.50	7.00	1